

for the Spray-Hit

Original operating instructions in German

Ⓓ



Product designation

Spray-Hit for spraying cold materials

Type

5 - 9 liters/ 10 - 17 liters

Year of manufacture

2026

Identification

Grease or ice sprayer

Creation date / revision

2025-01 / V.002.0

Manufacturer and address

Frisch Spritzmatic GmbH
Ramminger street 4
D- 89129 Öllingen

Tel: +49 (0)7345 20095 0

Web: www.frisch-spritzmatic.de

Fax: +49 (0)7345 20095 20

E-mail: info@frisch-spritzmatic.de

1	Important safety instructions	3
1.1	About these operating instructions and other important user information	3
1.1.1	Scope of these operating instructions	3
1.1.2	Terms used	3
1.1.3	Storage, provision and transfer	3
1.1.4	What these operating instructions cannot do	4
1.2	Symbols and signal words used	5
1.3	Ensure authorized persons	7
1.3.1	Operator	7
2	Requirements for safe operation	8
2.1	Intended use	8
2.2	Improper use and use contrary to the intended purpose	8
2.3	Obligations of the operator	9
2.4	Obligations of the operating and maintenance personnel	9
3	Technical data and connected loads	10
4	Main components	11
4.1	Spare parts	12
5	Safety and transportation	13
5.1	Safety and protective equipment	13
5.2	Design and technical protective measures	13
5.3	Safety functions	13
5.4	Transportation and storage	13
5.5	Storage location	13
6	Preparing and spraying Spray-Hit	14
6.1	Filling the Spray-Hit	14
6.2	Spraying	15
7	Cleaning	16
7.1	Daily cleaning for perishable cold materials	16
7.2	Weekly cleaning for perishable cold materials	16
8	Disposal and emergency service	17
8.1	Waste disposal	17
8.2	Emergency and customer service	17
9	EC Declaration of Conformity	18

1 Important Safety instructions

Only use the Spray-Hit pressure container for the purpose described in these instructions. Otherwise you may endanger yourself or damage parts of this device.

You put yourself and others in danger if you operate the pressure pot incorrectly or do not observe the safety instructions or warnings. This can result in serious injury or considerable damage to property.

1.1 About these operating instructions and other important User information

This manual contains important descriptions and instructions as well as safety instructions and warnings about possible residual risks during handling and use. These operating instructions are essential for the safe and effective operation and handling of the pressure vessel.

1.1.1 Scope of these operating instructions

These operating instructions apply exclusively to the Spray-Hit for spraying cold materials specified on the cover sheet.

1.1.2 Terms used

Operator

The operator is the person who operates the pressure container and uses it as intended or has it operated by suitable and instructed persons.

Operator / operator

The operator/operator is defined as anyone who operates the pressure vessel themselves or is assigned to do so by the operator.

Trained specialist

A trained specialist is a person who has acquired knowledge of mechanical and electrical systems on the basis of their specialist training.

1.1.3 Storage, provision and Transfer

Storage and provision

- ▶ Keep
 - these operating instructionsalways ready to hand in the operating environment of the device.

Handing over to others

If the Spray-Hit is ever moved to another location or handed over to another operator:

- ▶ Hand over
 - these operating instructions andto subsequent operators and users.

1.1.4 What these operating instructions cannot do

Ensure the qualification of operating and maintenance personnel

Requirements for qualifications and specialist knowledge for certain activities are specified in this manual and in the applicable documents.

However, these instructions cannot provide the necessary specialist knowledge.

If you do not have the required qualifications for certain activities yourself:

- ▶ Have activities for which specialist knowledge is required carried out exclusively by specialists with the appropriate training.
- ▶ Never attempt to carry out activities yourself for which you do not have the necessary qualifications.

Research operating regulations

Depending on the country and state in which the pressure vessel is operated, there are different operating regulations that the operator and user must observe.

Due to these differences, the requirements of the regulations cannot be detailed in these operating instructions.

In addition, the rules and regulations for accident prevention and environmental protection applicable to the place of use as well as any work and operating instructions of the operator/operating site must be observed.

- ▶ Find out about any additional operating regulations that apply.

In-house instructions

Operating or accident prevention regulations may make internal operating and work instructions necessary. These may specify additional safety and warning instructions as well as any additional personal protective equipment required.

In addition to these operating instructions, the necessary behavior for persons working on or with the pressure vessel may also be required here.

- ▶ If necessary, supplement these instructions with your own internal instructions.

Teaching and instruction

These operating instructions provide step-by-step instructions for working safely and effectively on and with the system. Nevertheless, it is essential that every person who is to work on or with the Spray-Hit is instructed and trained in detail.

Operating and accident prevention regulations also require the operator to do this.

- ▶ As the operator, instruct and instruct every person who is to work on or with the Spray-Hit.
- ▶ Take these instructions and any existing operating and work instructions into account.
- ▶ In particular, provide information on all safety and warning instructions.

1.2 Symbols used and signal words

All safety instructions and warnings in these instructions have been clearly highlighted. The following symbols and signal words have been used for warnings.

WARNING



Warns you of dangers **that could lead to fatal or serious injury** to persons if you do not follow these instructions.

or

 **WARNING**, directly in the context of an instructive part of these operating instructions

Safety chapter

Safety chapters are entire sections containing safety-related information that is essential for safe and effective operation and handling.

Hazards are also specified by the **following pictograms**:



Warning of hazards, which are further specified in the warning notice



Warning **of corrosive substances**

Mandatory symbols used in these instructions:



Observe **operating instructions**

Other **signs and symbols** used in these instructions: **Cross-**



references

Cross-references in these operating instructions are marked with this symbol or in *italics*.

1 Important safety instructions

▶ Request for action

Requests for action are marked with this symbol.

✓ Intermediate or final result of an action or series of actions

This information makes it easier to recognize whether the procedure of a step-by-step instruction has been successfully completed.

■ Bullet points

indicate enumerations in descriptive and instructional parts of these operating instructions.



Operator

1.3 Authorized persons ensure

Ensure qualified personnel - training and instruction

Inadequately qualified personnel can cause personal injury and property damage due to operating errors.

Only work with the pressure vessel if you have

- have read and understood the contents of these operating instructions and
- have received additional instruction on safe operation.

The descriptions and instructions contained herein require the specialist knowledge of an instructed operator.

If the use of a specialist is required for a named activity, this person must be demonstrably able to recognize dangers and risks that may arise from the respective activity or that may arise in the process due to their training and professional activity.

- ▶ Always comply with the necessary requirements for the permitted groups of persons.
- ▶ Observe the qualification requirements listed below.
- ▶ Also comply with the relevant accident prevention regulations and environmental protection regulations.

The necessary qualifications of the personnel carrying out the work and descriptions of the permitted or prohibited activities are summarized in the following subsections.

Warning against incorrect operation due to the influence of drugs, medication or alcohol

- ▶ Never work on or with the Spray-Hit if you are
 - under the influence of alcohol,
 - under the influence of alcohol, drugs or medication.

1.3.1 Operator

Use	
Person in these instructions	Operator / operator with training and instruction <div style="text-align: right;"></div>
Necessary qualification	<ul style="list-style-type: none"> ■ Operating instructions read and understood ■ Familiar with all basic regulations on occupational safety, accident prevention and environmental protection ■ Instructed and trained in the safe handling of the system and its components
Permitted activities	<ul style="list-style-type: none"> ■ Operating ■ Cleaning and maintenance work ■ Inspection activities
Prohibited activities	<ul style="list-style-type: none"> ■ Maintenance ■ Correcting faults and defects ■ Repairing

2 Requirements for safe operation

Comply with the basic rules of conduct

- ▶ Only use the Spray-Hit for the intended use described in these operating instructions.
- ▶ Never work with the Spray-Hit if protective devices are missing or if you can detect a defect.
- ▶ In such cases, have the system repaired before attempting to pressurize it again.
- ▶ Never exceed the prescribed maximum pressure.
- ▶ Always keep your working environment clean and tidy.
- ▶ Ensure that the floor is non-slip and level and that there is sufficient lighting at your workplace.
- ✓ This will help you to avoid unforeseeable safety risks when handling the pressure vessel.

2.1 Intended use

The Spray-Hit is built in accordance with the state of the art and recognized safety regulations. Nevertheless, improper use or use contrary to the intended purpose may result in danger to life and limb of the user or third parties or damage to the pressure container or other property.
arise.

The Spray-Hit is intended exclusively for the following activities:

- Spraying egg, release wax and other materials to be processed cold

The Spray-Hit may only be used as described in these operating instructions.

- Work,
- operating and
- operating modes described in these operating instructions.

The Spray-Hit must always be in

- in perfect technical condition and
- installed and operated in a safety and hazard-conscious manner.

In particular, any damage that could impair safety must be rectified immediately.

Any other use is not in accordance with the intended use and is therefore not permitted.

2.2 Improper use and use contrary to the intended purpose

The following are not intended use

- operation outside the ambient and operating conditions specified in these instructions or
- any operation outside the specified intended and permitted use or
- handling / processing or treatment of products not specified in these instructions or
- the operation and/or handling of the pressure vessel during any phase of its life by insufficiently qualified personnel.

The following is expressly prohibited

- the operation of all components within potentially explosive atmospheres.

2.3 Obligation of the operator

Overall responsibility for safe operation

The operator bears overall responsibility for the safe operation of the Spy-Hit during all phases of its life and specifies the rules and boundary conditions for the necessary organization.

The operator ensures compliance with all necessary operating, usage and environmental conditions.

All operating and maintenance personnel must be appropriately trained and instructed by the operator on the basis of the operating instructions and informed about the local, operation-specific hazards.

The operator must ensure that

- these operating instructions are always kept within easy reach at the Spray-Hit and
- damaged or illegible operating instructions are replaced immediately.

The operator undertakes to

only allow persons to work with the Spray-Hit who

- have read and understood these operating instructions,
- are familiar with the basic regulations on occupational safety, accident prevention and environmental protection and
- have been instructed in the safe handling of the Spray-Hit (instruction) and thus
- meet the requirements and qualifications specified in these instructions.

Furthermore, the operator undertakes

that maintenance work will only be carried out by specialists who

- have read and understood these operating instructions,
- are familiar with the basic regulations on occupational safety, accident prevention and environmental protection and
- have been specially trained for the respective activity.

2.4 Obligation of the operating and maintenance personnel

Every person who works with the Spray-Hit is obliged to

- to read and observe these operating instructions and
- follow all safety and warning instructions without exception,
- to use the pressure container only when it is in perfect technical condition and in accordance with its intended use, in a safety-conscious and hazard-conscious manner and in compliance with the operating instructions, and
- to immediately rectify any faults that may impair safety and, if necessary, have them rectified.

3 Technical data and connected loads



3 Technical data and Connected loads

Permissible ambient conditions	
Temperature during transportation	-5°C to +50°C
Temperature during storage / operation	+5°C to +50°C
Relative humidity	max. 85% in the specified temperature range

Performance and load capacity	
Designation	Spray-Hit
Utilization	If required

Connected loads	
Compressed air	max. 6 bar

4 Main components

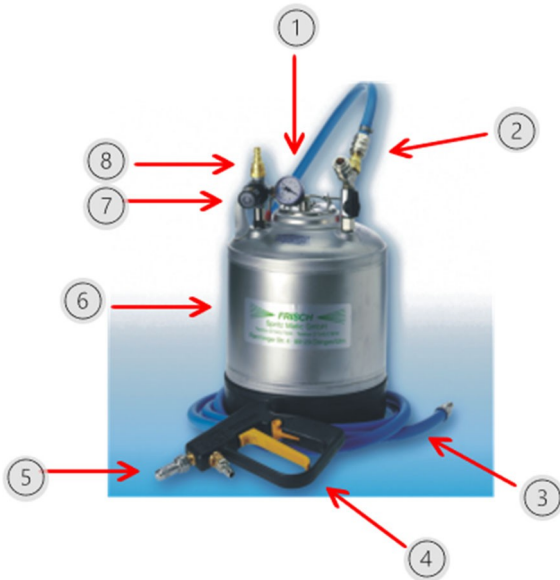

Main components of the Spray-Hit

- 1 Pressure gauge
- 2 Material connection (variable)
- 3 Material hose
- 4 Spray gun
- 5 Nozzle
- 6 Pressure tank
- 7 Pressure regulator
- 8 Compressed air connection

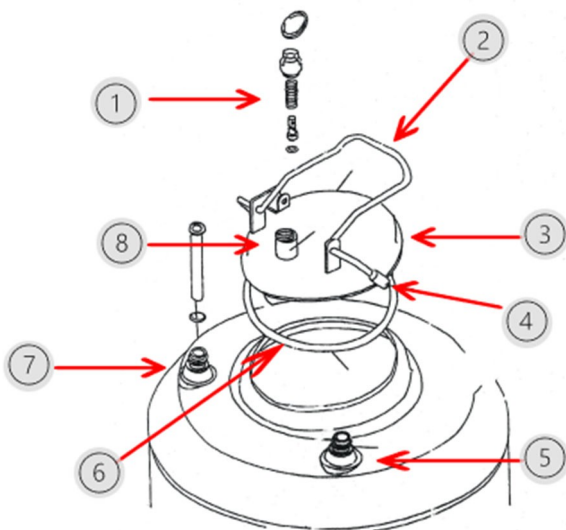

- 1 Safety valve
- 2 Clamping bracket
- 3 lid
- 4 Lid opener
- 5 Material fittings connection
- 6 Lid seal/ O-ring
- 7 Compressed air fittings connection
- 8 Safety valve connection

4 Main components

4.1 Spare parts

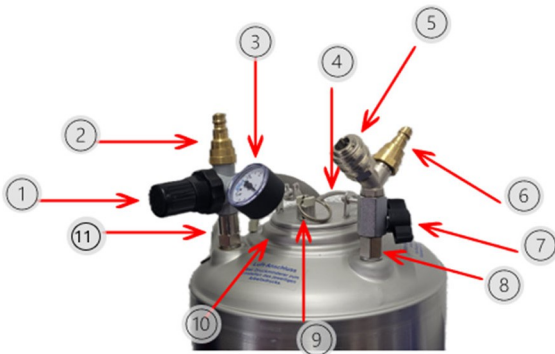

Spare parts available to order:

- 1 Pressure regulator
- 2 Compressed air connection
- 3 pressure gauge
- 4 Cover (complete)
- 5 One-hand coupling
- 6 Cleaning connection (variable)
- 7 Ball valve
- 8 Sleeve
- 9 Safety valve
- 10 Pressure tank seal
- 11 Reducing nipple long

Only use original spare parts!

5 Safety and Transportation

5.1 Safety and Protective devices

Descriptive parts of the manual do not contain instructions for use

This chapter is a descriptive part of the operating instructions. It is intended to aid understanding and **does not** instructions.

5.2 Design and technical Protective measures

Design measures

Design measures to prevent hazards have already been taken into account and integrated during the design phase.

Technical measures and user information

Despite the design and construction of the pressure vessel according to the state of the art, residual risks cannot be completely ruled out.

Therefore, in addition to the design measures, technical protective measures to further reduce exposure to hazards and user information for quick and better recognition of residual risks were also implemented.

5.3 Safety functions

Safety function and event	Risk reduction and ✓ reaction
Safety valve Max. Pressure exceeded	✓ Safety valve opens. Pressure escapes

5.4 Transport and Storage

Before transportation

- ▶ Release the pressure.
- ▶ Remove all liquid from the spray hit.
- ▶ Protect the pressure container against moisture, dirt and impact.

5.5 Storage location

Take suitable measures to protect the Spray-Hit before, during and at the end of storage against

- Damage,
- Ingress of water, dirt, dust or other substances,
- strong fluctuations in temperature and humidity,
- frost,
- direct sunlight,
- contact with chemicals and
- condensation.

6 Preparing the Spray-Hit and spraying

The instructions in this chapter are intended for the operator	
Person in these instructions	<ul style="list-style-type: none"> Operator / operator with training and instruction 
Necessary training and permitted activities	See <i>section 1.3.1 Operator</i> of these operating instructions.

WARNING



Risk of injury from explosion due to overpressure

- ▶ Never exceed the maximum permissible pressure of 6 bar as specified in *section 3 Technical data and connected loads*.
- ▶ Make sure that the pressure has been released.

6.1 Filling the Spray-Hit

Fill the Spray-Hit with

- If possible, liquid pasteurized "whole egg" or
- Resin-free release agents or
- brightener or
- egg substitutes
- sugar solutions

Always follow the mixing instructions of the respective manufacturer

Do not use emulsion!



Releasing the pressure

- ▶ Pull the safety valve on the ring upwards
 - ✓ Compressed air escapes
- When there is no more pressure, then
 - ▶ Release the ring.
 - ✓ The safety valve closes again



- ▶ To do this, fold down the clamping bracket.
- ▶ Hold the lid firmly on the clamping bracket and
- ▶ turn the lid by $\frac{1}{4}$ turn
 - ✓ The lid can be removed
- ▶ Fill the Spray-Hit to a maximum of $\frac{3}{4}$ of its capacity. (5 or 10 liters depending on the capacity)



- ▶ Replace the lid in the pressure container.

Ensure that the lid seal is not dirty or damaged and that it is evenly positioned all around the oval container opening.

- ▶ Close the clamping bracket



- ▶ Close the ball valve and
- ▶ pressurize the Spray-Hit by connecting the compressed air.

6.2 Spraying

- ▶ Only spray from an appropriate distance.
- ▶ Only ever spray briefly with quick movements.
- ✓ A short eye stroke is enough to create a thin layer.

To achieve a different spraying result, change the nozzle.

WARNING



Risk of injury due to explosion

- ▶ Before opening the Spray-Hit, **always** make sure that the pressure in the pressure container has been released.
- ▶ After ending the spraying process, opening the container for refilling or cleaning, the pressure must always be released first! See *point 6.1 Filling the Spray-Hit*.

7 Cleaning

7.1 Daily cleaning for perishable cold materials

After using the Spray-Hit with perishable cold materials, the hose system must be cleaned daily. To do this



Flush the hose system (not with set 3 oil)

- ▶ Close the ball valve (1)
- ▶ Connect the supplied cleaning hose to fresh water and the cleaning connection (2)
- ▶ Flush the hose system with sufficient warm water

7.2 Weekly cleaning for perishable cold materials

WARNING



Danger from corrosive substances

- ▶ Use protective gloves and safety goggles



- ▶ Carry out daily cleaning as described in *section 7.1* Daily cleaning for perishable cold materials.
- ▶ Fill the Spray-Hit with disinfectant cleaning agent as described in *point 6.1* Filling the Spray-Hit and spray a little through the gun.
- ▶ Allow the cleaning agent to work in the hose and gun for a few minutes.
- ▶ Remove the legal cleaning solution and rinse the
- ▶ rinse the pressure container, hose and gun with plenty of clean water We recommend

our *P & R cleaning agent* for this purpose.

8 Disposal and Emergency service

8.1 Disposal



Dispose of individual parts safely

- ▶ Have the materials disposed of in accordance with local regulations or
- ▶ return the components to the manufacturer.
- ▶ Never dispose of electrical or electronic components in household waste.

8.2 Emergency and Customer service

To solve technical problems and malfunctions, please contact the Frisch Spritzmatic GmbH service team.

Frisch Spritzmatic GmbH
Ramminger Straße 4
D- 89129 Öllingen

Tel: +49 (0)7345 20095 0

Web: www.frisch-spritzmatic.de

Fax: +49 (0)7345 20095 20

E-mail: info@frisch-spritzmatic.de

9 EC Declaration of Conformity



9 EC Declaration of Conformity

(Original EU Declaration of Conformity) according to
Pressure Equipment Directive 2014/68/EU, Annex IV

EU-ABT.L 189/164 dated 27.06.2014

We hereby declare as manufacturer and under our sole responsibility that the following pressure equipment assembly, in its design and construction as well as in the version placed on the market by us, complies with the relevant provisions of the above-mentioned harmonization legislation.

All parts in contact with foodstuffs parts of the product correspond to also the requirements of regulations

EU on food materials and plastics

REGULATION (EC) No 1935/2004,

REGULATION (EU) No 10/2011,

its amending regulations and on good manufacturing practice for food materials and articles

REGULATION (EC) No. 2023/2006,

EU Official Journal L 338/4 of 13.11.2004,

EU OJ L 12/1 of 15.01.2011 and

EU OJ L 384/75 of 29.12.2006

Pressure equipment assembly:	Category I
Conformity assessment:	Module A
Product designation	Spray-Hit
Functional description	Spraying of cold materials
Model designation:	0300
Type designation	Set 3
Trade name	Spray-Hit
Manufacturer and address	Frisch Spritzmatic GmbH Ramminger Straße 4 D- 89129 Öllingen

Authorized representative for documentation Jürgen

Frisch

Applied harmonized standards, in particular

Safety of machinery and equipment

EN ISO 12100:2010 - Risk assessment

EN 1672-2: 2005+A1:2009 - Food processing machinery

Technical documentation

EN IEC / IEEE 82079-1:2021 - Requirements Instructions for use

Jürgen Frisch - Managing Director

The handwritten signed original document is part of the documentation accompanying the product.